

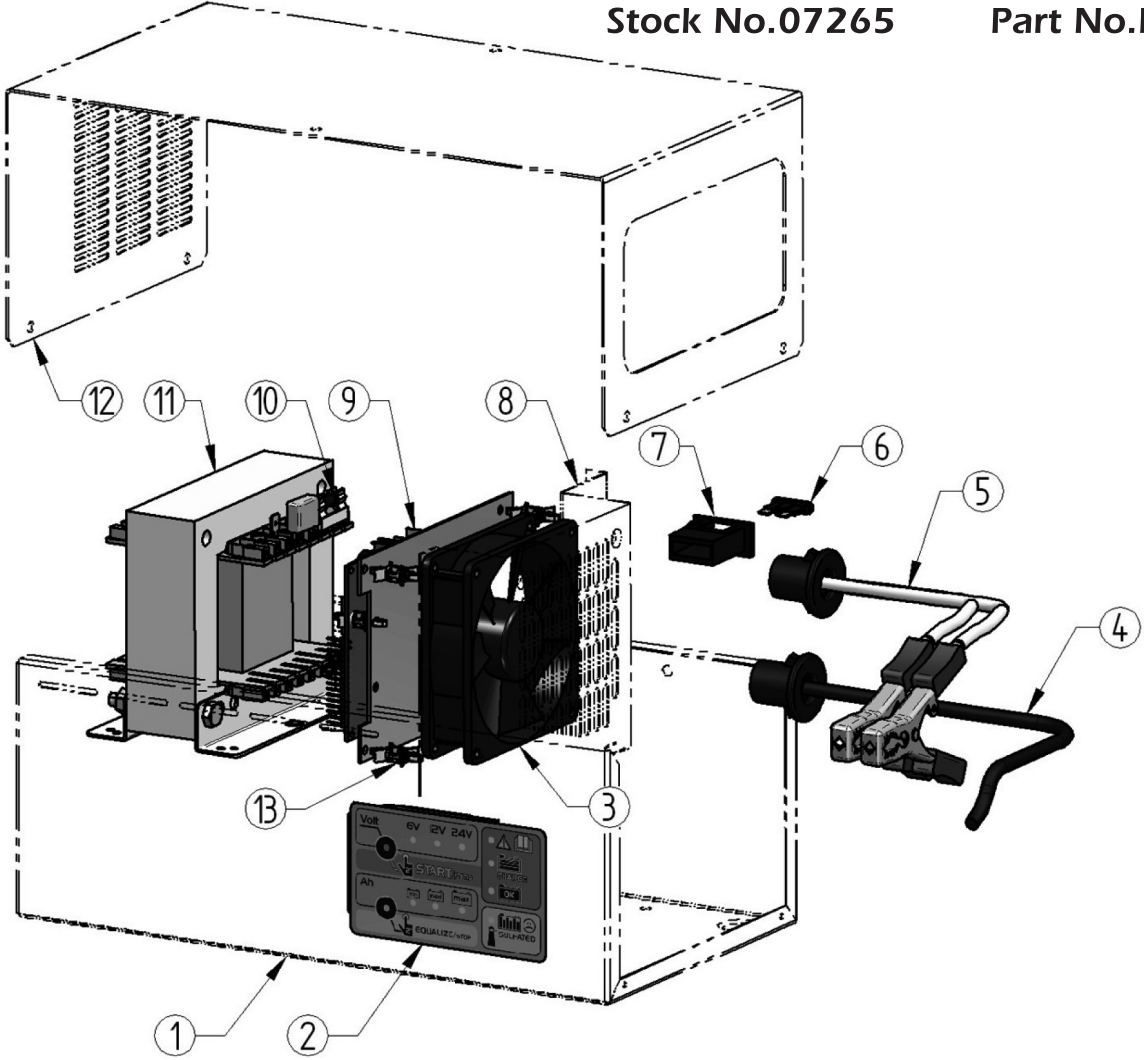

SPARE PARTS LISTING & DRAWING SHEET FOR
**6/12/24 Volt 11 Amp
 Battery Charger**

Stock No.07265

Part No.BC1113D



| KEY No. | PART No. | STOCK No. | DESCRIPTION |
|---------|----------|-----------|---------------------|
| 1 | Y-710228 | 07647 | Bottom. |
| 2 | Y-760311 | 07648 | Keyboard. |
| 3 | Y-673079 | 07649 | Exhaust Fan. |
| 4 | Y-741568 | 07650 | Input Supply Cable. |
| 5 | Y-741534 | 07651 | Cables and Clamps. |
| 6 | Y-010293 | 07652 | Fuse 15Amp. |
| 7 | Y-658051 | 07653 | Fuse Holder. |

| KEY No. | PART No. | STOCK No. | DESCRIPTION |
|---------|----------|-----------|----------------------|
| 8 | Y-714986 | 07654 | Separating Panel. |
| 9 | Y-760310 | 07655 | Electronic PC Board. |
| 10 | Y-658066 | 07656 | Fuse 2,5AT. |
| 11 | Y-751935 | 07657 | Transformer. |
| 12 | Y-710229 | 07658 | Top Cover. |
| 13 | Y-630093 | 07659 | Spacer. |

Helpline: (023) 8049 4344. Sales Desk: (023) 8049 4333. General Enquiries: (023) 8026 6355.

DRAPER TOOLS LTD, HURSLEY ROAD, CHANDLER'S FORD, EASTLEIGH, HANTS. SO53 1YF U.K. internet: www.draper.co.uk e-mail: sales@drapertools.com