

- **DRAPER TOOLS LIMITED,**
Hursley Road, Chandler's Ford,
Eastleigh, Hampshire. SO53 1YF. U.K.
- **Helpline:** (023) 8049 4344
- **Sales Desk:** (023) 8049 4333
- **General Enquiries:** (023) 8026 6355
- **Service/Warranty Repair Agent**
For aftersales servicing or warranty repairs, please
contact the Draper Tools Helpline for details of an
agent in your local area.

YOUR DRAPER STOCKIST

DBDH1016



DRAPER[®]

INSTRUCTIONS FOR **Gen 2 Master Kit**

Stock No.16423

Part No.SSK18

IMPORTANT: PLEASE READ THESE INSTRUCTIONS CAREFULLY TO ENSURE THE SAFE AND EFFECTIVE USE OF THIS PRODUCT.



CE

DRAPER[®]

GENERAL INFORMATION

These instructions accompanying the product are the original instructions. This document is part of the product, keep it for the life of the product passing it on to any subsequent holder of the product. Read all these instructions before assembling, operating or maintaining this product.

This manual has been compiled by Draper Tools describing the purpose for which the product has been designed, and contains all the necessary information to ensure its correct and safe use. By following all the general safety instructions contained in this manual, it will ensure both product and operator safety, together with longer life of the product itself.

All photographs and drawings in this manual are supplied by Draper Tools to help illustrate the operation of the product. Whilst every effort has been made to ensure the accuracy of information contained in this manual, the Draper Tools policy of continuous improvement determines the right to make modifications without prior warning.

1. PREPARING THE GEN 2 MASTER KIT

1.1 INTRODUCTION

This Front Hub Wheel tool is designed to remove the front bearing housing from the drive flange without the need of a press.

- **APPLICATION:** 62mm - Audi A2, VW Lupo(front).
66mm - Skoda Fabia, VW Fox(front), VW Polo.
72mm - Audi A1, Audi A2, Seat Cordoba, Seat Ibiza, Skodia Fabia, Skoda Roomster, VW Polo(front), VW Fox with PAS(front).
78mm - Ford Focus II, Ford C-Max, Volvo C30, Volvo C70, Volvo S40, Volvo V50(front), Mazda 3.
82mm - Ford Mondeo, Ford Galaxy, Ford S-Max, Land Rover Freelander 2, Volvo S80, Volvo V70, Volvo XC60, Volvo XC70.
85mm - VW Multivan, VW Touareg, VW Transporter(front & rear).

1.2 PRECAUTIONS

- Make sure the vehicle is securely elevated on a vehicle lift or supported with axle stands.
 - Wear suitable eye protection.
 - Always grease the thrust nut assembly and force screw before and after every job.
 - **DO NOT USE AIR TOOLS OR CORDLESS IMPACT WRENCHES WITH THIS PRODUCT.**
 - **IMPORTANT:** Do not use air tools or cordless impact wrenches on this kit. Always wear goggles and gloves. Lubricate force screw before and after use.
 - **NOTE:** Due to the forces involved when using this tool, the force screw must be considered as a consumable component
 - Incorrect use of this product will not be covered by our warranty.
-

NOTES

5. SETTING THE 82mm FITTING/REMOVAL TOOL

NOTE: Grease the screw threads before using this tool. Before using this tool ensure that the ABS sensor has been removed.

WARNING: Do not use impact tools when removing.

5.1 REMOVING THE BEARING

1. Select a 4 long pin configuration.
2. Fit black half moon plates and back pushing disc.
3. Assemble with a lubricated force screw and nut.
4. Remove bearing by turning the nut and force screw with 2 x spanners (not included).

WARNING: Do not use impact tools when installing.

5.2 INSTALLING THE PLATES

1. Select a 4 short pin configuration.
2. Fit half moon silver plates to push against the locking ring.

WARNING: Do not push against the inner bearing as this will overload the bearing.

3. Assemble with screw, nut and silver back plate (ensuring the lip faces the bearing) install by turning the screw and nut with suitable spanners.
4. Remove all parts.

IMPORTANT: It is likely that the bearing studs are not always pressed securely into the tool and this may lead to the silver plates being stuck to the bearing. In this instance, it might be necessary to pull the stud in using a sturdy washer and wheel nut.

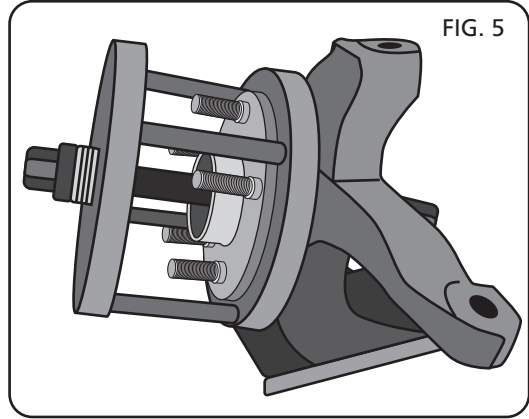

FIG. 5

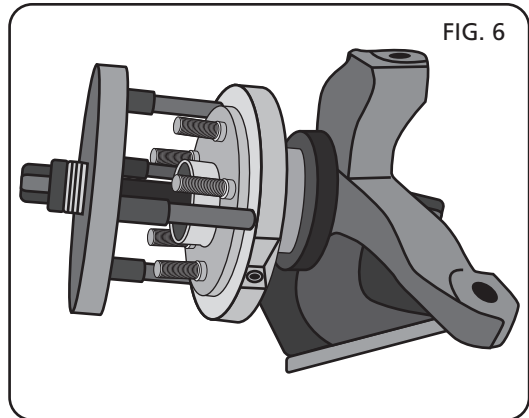

FIG. 6

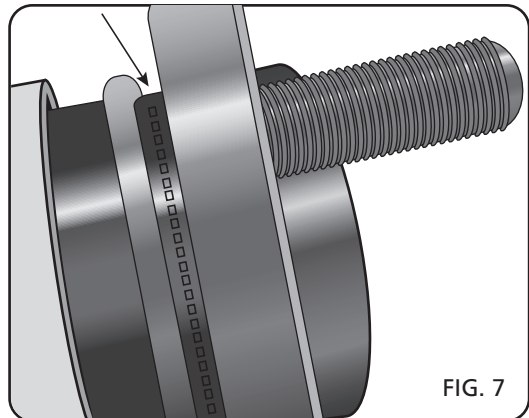
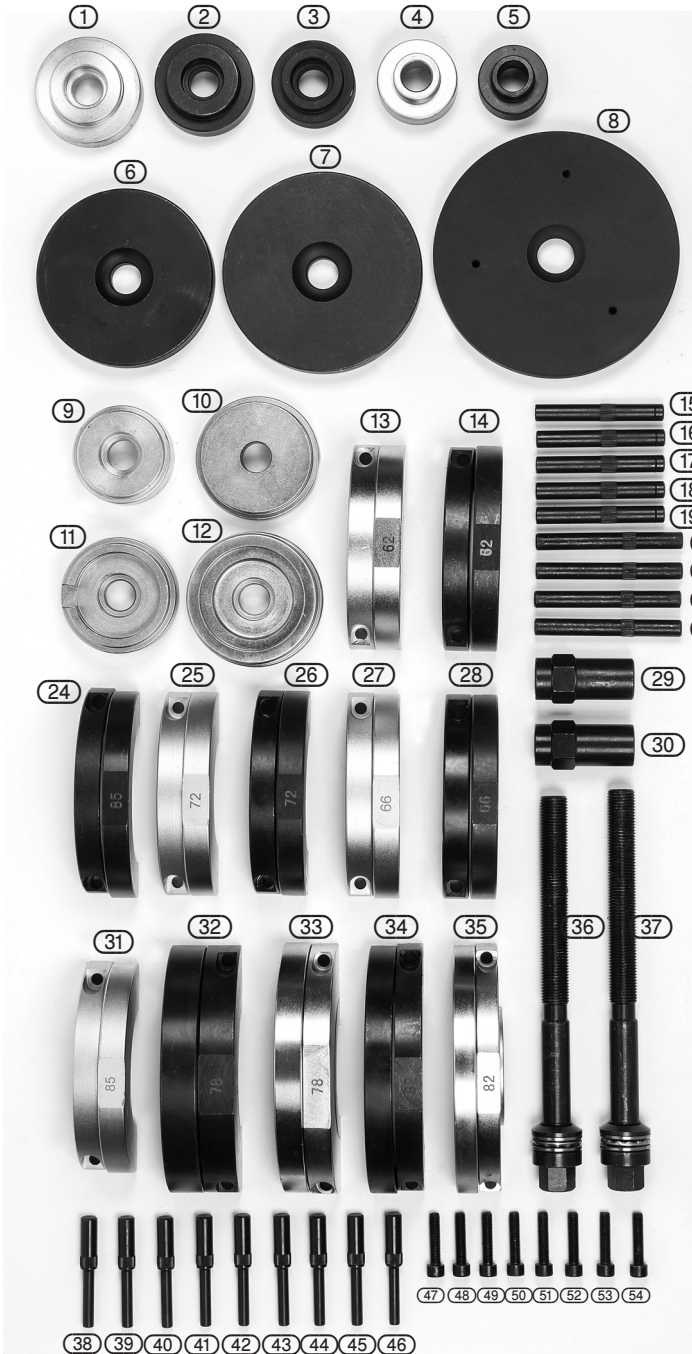

FIG. 7

2. TECHNICAL DESCRIPTION

2.1 IDENTIFICATION



- ① Install adaptor.
- ② Removal adaptor.
- ③ Removal adaptor.
- ④ Install adaptor.
- ⑤ Removal adaptor.
- ⑥ Pressure plate.
- ⑦ Pressure plate.
- ⑧ Pressure plate.
- ⑨ Adaptor.
- ⑩ Adaptor.
- ⑪ Adaptor.
- ⑫ Adaptor.
- ⑬ 62mm install plates.
- ⑭ 62mm removal plates.
- ⑮ Pin.
- ⑯ Pin.
- ⑰ Pin.
- ⑱ Pin.
- ⑲ Pin.
- ⑳ Pin.
- ㉑ Pin.
- ㉒ Pin.
- ㉓ Pin.
- ㉔ 85mm removal plates.
- ㉕ 72mm install plates.
- ㉖ 72mm removal plates.
- ㉗ 66mm install plates.
- ㉘ 66mm install plates.
- ㉙ Force screw 1 of 2.
- ㉚ Force screw 1 of 2.
- ㉛ 85mm install plates.
- ㉜ 78mm removal plates.
- ㉝ 78mm install plates.
- ㉞ 82mm removal plates.
- ㉟ 82mm install plates.
- ㊱ Force screw 2 of 2.
- ㊲ Force screw 2 of 2.
- ㊳ } Pin
- ㊴ } Bolt.
- ㊵ } Bolt.

3. REMOVING/INSTALLING BEARINGS AND PLATES

WARNING: Do not use powered or manual impact tools when removing.

3.1 GENERAL INSTRUCTIONS

1. Select correct size fitting/removal plates and backing pad.
2. Grease the force screw.
3. Ensure you are using the correct pin configuration.
4. Follow vehicle or bearing manufacturer's fitting guidelines. Draper Tools will not be responsible for damage caused by the incorrect use of this tool.

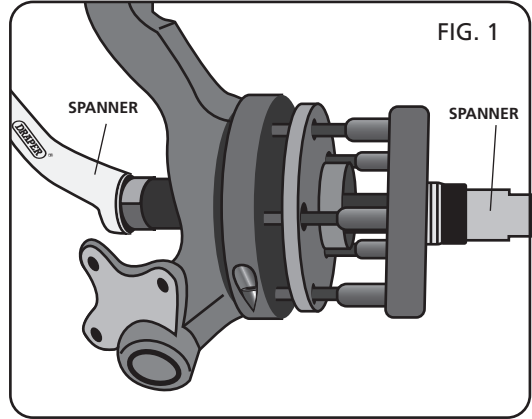

3.1 REMOVING THE BEARING

1. Select 4 or 5 pin configuration.
2. Fit grey half moon plates and backing plate.
3. Assemble with a **lubricated** force screw and nut.
4. Turn the force screw with a spanner (not supplied) while holding the nut with a spanner (not supplied).

WARNING: Do not use powered or manual impact tools when removing.

3.2 INSTALLING THE PLATES

1. Select 4 or 5 pin configuration.
2. Fit silver plates and push against the locking ring.

WARNING: Do not push against the inner bearing as this will overload the bearing. Only apply press force to the outer bearing ring.

3. Assemble with screw, nut and silver back plate and install by turning screw and nut with suitable spanners.
4. Remove all tool parts.

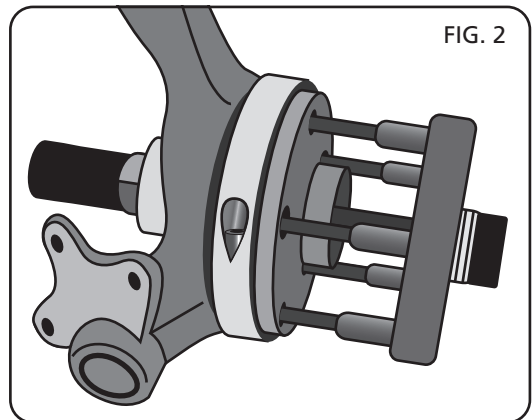

4. SETTING THE 78mm FITTING/REMOVAL TOOL

NOTE: Grease the screw threads before using this tool. Before using this tool ensure that the ABS sensor has been removed.

WARNING: Do not use powered or manual impact tools when removing.

4.1 REMOVING THE BEARING

1. Select 4 pin configuration.
2. Fit grey half moon plates and back pushing disc.
3. Assemble with a lubricated force screw and nut.
4. Remove bearing by turning the nut and force screw with 2 x spanners (not included).

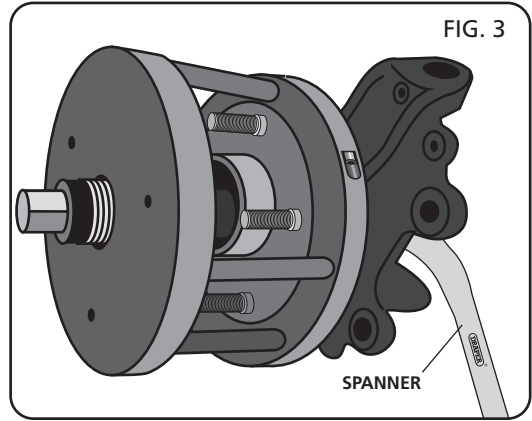

WARNING: Do not use powered or manual impact tools when removing.

3.2 INSTALLING THE PLATES

1. Select 4 pin configuration.
2. Fit silver half moon plates to push against the locking ring.

WARNING: Do not push against the inner bearing as this will overload the bearing.

3. Assemble with screw, nut and silver back plate and install by turning screw and nut with suitable spanners.
4. Remove all parts.

