

DRAPER®

INSTRUCTIONS FOR Oil Filled Radiators

Stock No.24449	Part No.HEAT6-1000
24448	HEAT6-450
24452	HEAT7-1500
24453	HEAT7-2500

IMPORTANT: PLEASE READ THESE INSTRUCTIONS CAREFULLY TO ENSURE THE SAFE AND EFFECTIVE USE OF THIS PRODUCT.



CE

DRAPER®

GENERAL INFORMATION

These instructions accompanying the product are the original instructions. This document is part of the product, keep it for the life of the product passing it on to any subsequent holder of the product. Read all these instructions before assembling, operating or maintaining this product.

This manual has been compiled by Draper Tools describing the purpose for which the product has been designed, and contains all the necessary information to ensure its correct and safe use. By following all the general safety instructions contained in this manual, it will ensure both product and operator safety, together with longer life of the product itself.

All photographs and drawings in this manual are supplied by Draper Tools to help illustrate the operation of the product. Whilst every effort has been made to ensure the accuracy of information contained in this manual, the Draper Tools policy of continuous improvement determines the right to make modifications without prior warning.

1. TITLE PAGE

1.1 INTRODUCTION:

USER MANUAL FOR:

OIL FILLED RADIATORS

Stock nos. 24449, 24448, 24452 & 24453.

Part nos. HEAT6-1000, HEAT6-450, HEAT7-1500 & HEAT7-2500.

1.2 REVISIONS:

Date first published June 2012.

As our user manuals are continually updated, users should make sure that they use the very latest version.

Downloads are available from: <http://www.drapertools.com/b2c/b2cmanuals.pgm>

DRAPER TOOLS LIMITED

HURSLEY ROAD

CHANDLER'S FORD

EASTLEIGH

HAMPSHIRE

SO53 1YF

UK

WEBSITE: www.draper.co.uk

PRODUCT HELPLINE: +44 (0) 23 8049 4344

GENERAL FAX: +44 (0) 23 8026 0784

1.3 UNDERSTANDING THIS MANUALS SAFETY CONTENT:

WARNING! Information that draws attention to the risk of injury or death.

CAUTION! Information that draws attention to the risk of damage to the product or surroundings.

NOTE! Important information.

1.4 COPYRIGHT © NOTICE:

Copyright © Draper Tools Limited.

Permission is granted to reproduce this publication for personal & educational use only.

Commercial copying, redistribution, hiring or lending is prohibited.

No part of this publication may be stored in a retrieval system or transmitted in any other form or means without written permission from Draper Tools Limited.

In all cases this copyright notice must remain intact.

2. CONTENTS

2.1 CONTENTS

	<i>Page content</i>	<i>Page</i>
1	TITLE PAGE	
	1.1 INTRODUCTION	2
	1.2 REVISION HISTORY.....	2
	1.3 UNDERSTANDING THIS MANUAL	2
	1.4 COPYRIGHT NOTICE	2
2	CONTENTS	
	2.1 CONTENTS	3
3	GUARANTEE	
	3.1 GUARANTEE	4
4	INTRODUCTION	
	4.1 SCOPE	5
	4.2 SPECIFICATION	5
	4.3 HANDLING & STORAGE	5
5	HEALTH & SAFETY INFORMATION	
	5.1 GENERAL SAFETY INSTRUCTIONS FOR HEATER USE	6
6	TECHNICAL DESCRIPTION	
	6.1 IDENTIFICATION	7
7	PREPARING THE HEATER	
	7.1 ASSEMBLY	8
8	OPERATING THE HEATER	
	8.1 SETTINGS.....	9
	8.2 THERMOSTAT OPERATION	9
	8.3 SAFETY DEVICE.....	9
9	MAINTENANCE	
	9.1 THE IMPORTANCE OF MAINTENANCE.....	10
10	DISPOSAL	
	10.1 DISPOSAL.....	11
11	EXPLANATION OF SYMBOLS	
	11.1 EXPLANATION OF SYMBOLS	12
	NOTES	13
	CONTACTS	16
	DECLARATION OF CONFORMITY	ENCLOSED

3. GUARANTEE

3.1 GUARANTEE

Draper tools have been carefully tested and inspected before shipment and are guaranteed to be free from defective materials and workmanship.

Should the heater develop a fault, please return the complete heater to your nearest distributor or contact Draper Tools Limited, Chandler's Ford, Eastleigh, Hampshire, SO53 1YF. England.

Telephone Sales Desk: (023) 8049 4333 or Product Helpline (023) 8049 4344.

A proof of purchase must be provided with the heater.

If upon inspection it is found that a fault occurring is due to defective materials or workmanship, repairs will be carried out free of charge. The guarantee period covering parts/labour is 12 months from the date of purchase. This guarantee does not apply to normal wear and tear, nor does it cover any damage caused by misuse, careless or unsafe handling, alterations, accidents, or repairs attempted or made by any personnel other than the authorised Draper warranty repair agents.

Note: If the heater is found not to be within the Terms of Warranty, repair and carriage charges will be quoted and made accordingly.

This guarantee applies in lieu of any other guarantee expressed or implied and variations of its terms are not authorised.

Your Draper guarantee is not effective unless you can produce upon request a dated receipt or invoice to verify your proof of purchase within the guarantee period.

Please note that this guarantee is an additional benefit and does not affect your statutory rights.

Draper Tools Limited.

Note: This heater is intended for domestic use only.

4. INTRODUCTION

4.1 SCOPE

These are oil filled radiators used to heat enclosed spaces.

4.2 SPECIFICATION

Stock no.	24448	24449	24452	24453
Part no.	HEAT6-450	HEAT6-1000	HEAT7-1500	HEAT7-2500
Rated voltage	230V~	230V~	230V~	230V~
Rated input.....	450W.....	1000W.....	1500W	2500W
Rated frequency.....	50Hz	50Hz	50Hz	50Hz
Power settings				
1	450W	1000W.....	600W	1000W
2	N/A	N/A	900W	1500W
3	N/A	N/A	1500W	2500W
No. of fins	5	11	7	11
Size (mm)	280x130x415	520x130x415.....	380x150x555	540x150x555
Weight	3.1kg	5.5kg	8.6kg.....	14.3kg

4.3 HANDLING & STORAGE

Care must be taken when handling and lifting. Dropping this heater will damage it and may also result in personal injury. This heater is not a toy and must be respected.

The environment will have a negative result on its operation if you are not careful. If the air is damp, components will rust. If the machine is unprotected from dust and debris; components will become clogged: And if not cleaned and maintained correctly or regularly the machine will not perform at its best.

5. HEALTH & SAFETY INFORMATION

5.1 GENERAL SAFETY INSTRUCTIONS FOR HEATER USE

- Read all instructions before using the heater.
- **WARNING: In order to avoid overheating, do not cover the heater.**
- The heater must not be located immediately below a socket-outlet.
- Do not use this heater with a programmer, timer or any other device that switches the heater on automatically, since a fire risk exists if the heater is covered or positioned incorrectly.
- Do not leave the heater unattended when in use.
- The guard of this heater is intended to prevent direct access to heating elements and must be in place when the heater is in use.
- The guard does not give full protection for young children, pets or infirm persons.
- **Do not use this heater in the immediate surroundings of a bath, shower or a swimming pool or any other damp environment that may produce condensation on the heater.**
- **WARNING: Do not position the heater in proximately to curtains and other combustible materials.**
- Allow sufficient time for the heater to cool before attempting to repackage or store.
- Store the heater out of the reach of children.
- Remove the plug from the socket when not in use.
- Remove the plug from the socket before carrying out adjustment, servicing or maintenance.
- **WARNING: Do not touch the heater when in use.**
- For domestic use only.
- Do not move the heater while in use.
- Mount this heater on a suitable, level, fire-proof flat surface.
- Do not stand heater on deep pile carpets.
- **WARNING: Not for use outdoors - for indoor use only.**
- Do not allow the heater to get wet-risk of electric shock.

5.2 CONNECTION TO THE POWER SUPPLY

Make sure the power supply information on the machine's rating plate are compatible with the power supply you intend to connect it to. This lathe comes supplied with a UK standard 3 pin plug fitted. It is designed for connection to a domestic power supply rated at 230V AC. Because it is constructed mostly of metal parts, it is a Class 1 machine; meaning, it must have an earth connection in the power supply. This is to prevent electrocution in the event of a failure.

Apart from replacing the fuse in the plug, no other electrical work is recommended on this heater.

6. TECHNICAL DESCRIPTION

6.1 IDENTIFICATION

HEAT7

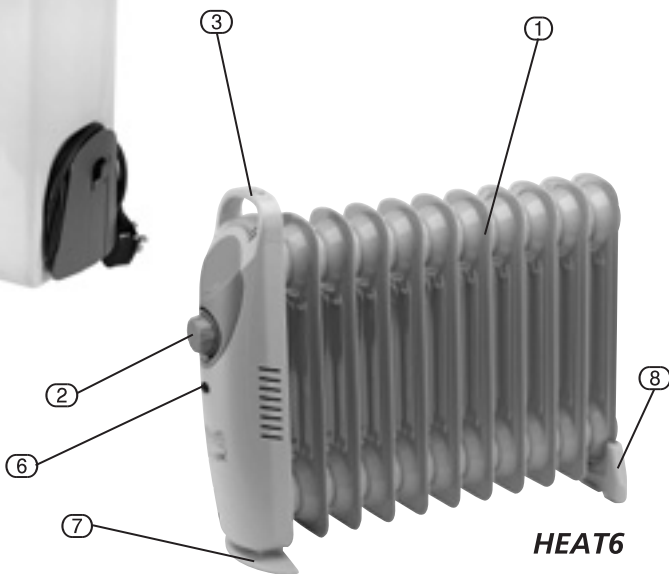
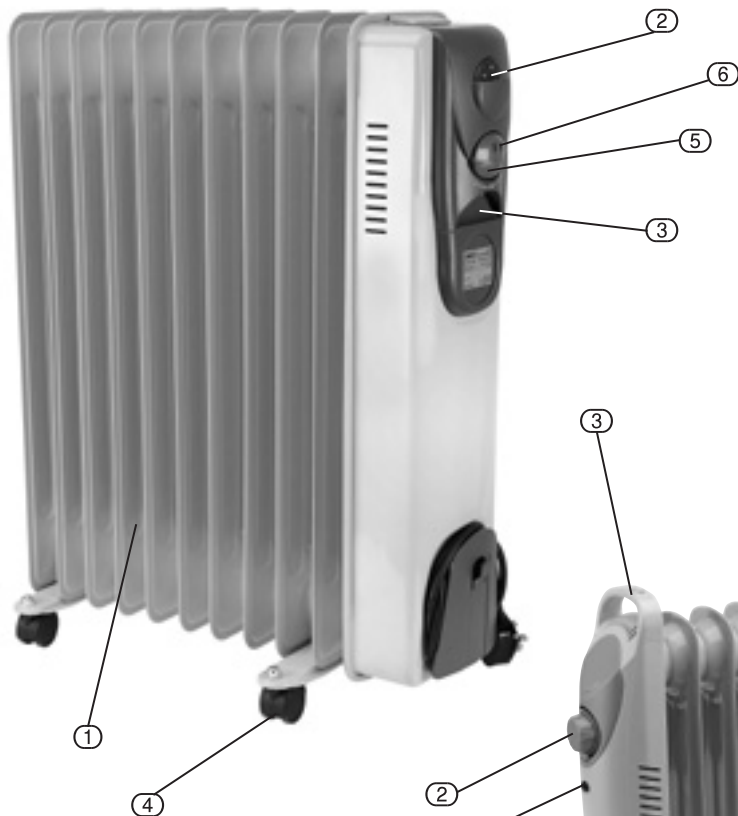

- ① Radiator fin.
- ② Thermostatic control dial.
- ③ Handle.
- ④ Castors (depending on model).

- ⑤ Output switch (HEAT7 only).
- ⑥ LED light.
- ⑦ Foot (depending on model).
- ⑧ Foot support.

7. PREPARING THE HEATER

7.1 ASSEMBLY

HEAT6 - FIGS.1 & 2

Attach feet to base of heater by sliding in front foot (7) until it clicks into place. Locate rear foot support (8) onto last fin base and push firmly until fully engaged.

HEAT7 - FIG.3

Bolt castor wheels (4) to support foot (4.1). Insert U-bracket (4.2) into support foot and locate between rear fin and push threaded section through hole ensuring support foot is located square to the base. Attach wing nut (4.3) and tighten firmly. Repeat with second support foot. Check all fixings are tight then invert, to ensure heater stands upright and secure.

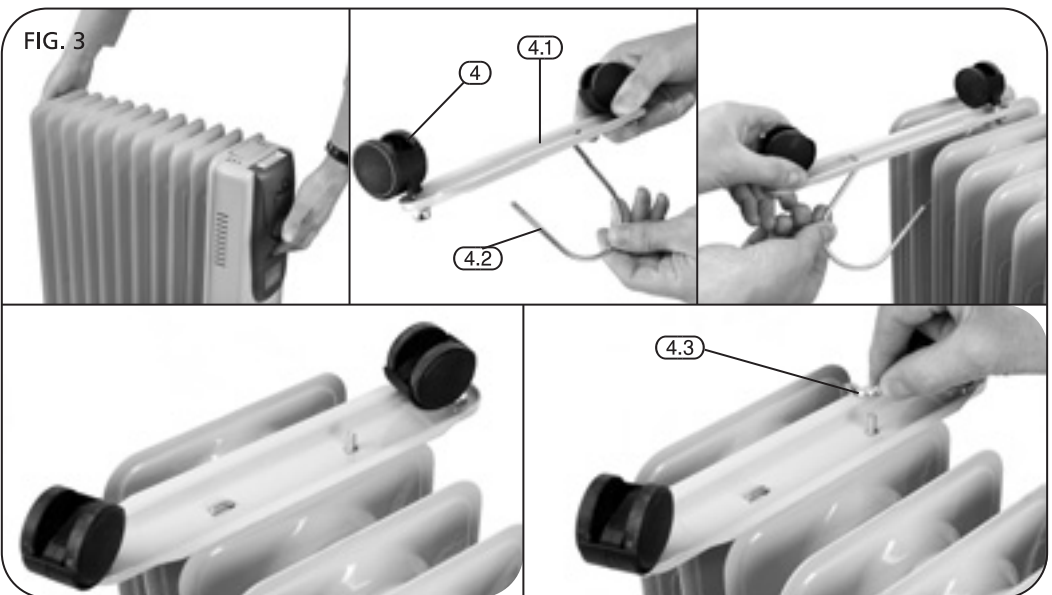
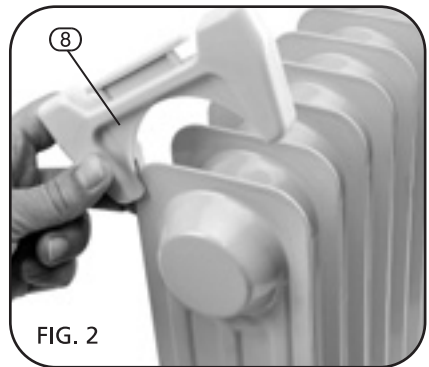
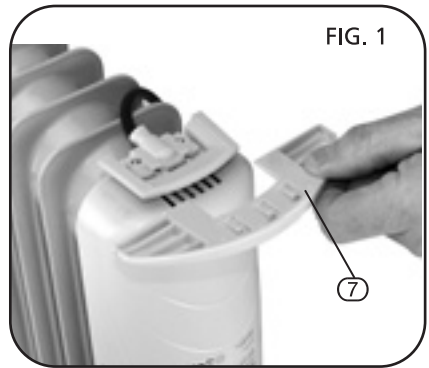

8. OPERATING THE HEATER

Note: It is normal when the heaters are first used or when they are turned on after having not been used for a long period of time, that the heater will emit smells or a small amount of fumes. This is normal and will disappear when the heater has been used for a short while. During use the heater may make a small amount of noise - this is normal as the oil moves inside the heater.

8.1 SETTINGS – FIG.4 (HEAT 7 ONLY)

Insert the plug into the power supply. HEAT7 models have heat control switches (5.1) and (5.2).

BUTTON	HEAT 7-1500 HEAT OUTPUT	HEAT 7-2500 HEAT OUTPUT
1	600W	1000W
2	900W	1500W
1 and 2	1500W	2500W

The LED light indicates which switches are operating.

8.2 THERMOSTAT OPERATION – FIG.5

Rotate the thermostat (2) to select the desired ambient temperature.

NOTE: The oil filled radiator will continue to radiate heat even when switched off - ensure it is fully cooled before moving the unit.

8.3 SAFETY DEVICE

The thermal cut-out activates in the event of the appliance over heating. In the event of the thermal cut-out activating, the heater must be switched off, unplugged and left to cool.

The cause for the appliance overheating must be addressed immediately and rectified.

Possible reasons for the appliance overheating include the outlet becoming covered, the inlet or outlet vents positioned too close to an object or the fan heater being left to run continuously.

When the unit is sufficiently cool, reconnect it to the mains and switch on again.

NOTE:-

The oil filled radiators are **NOT** designed for wall mounting.

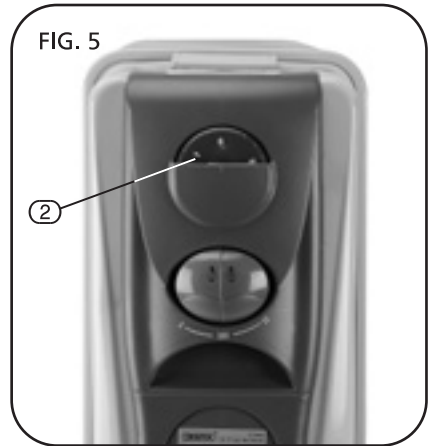
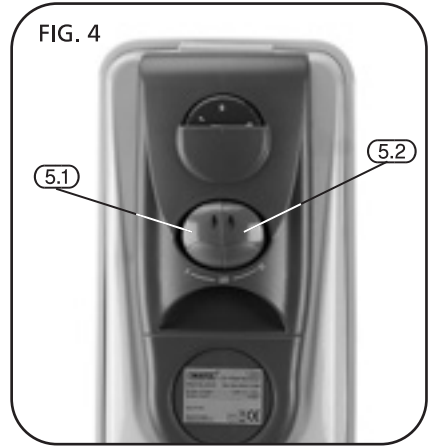

9. MAINTENANCE

9.1 THE IMPORTANCE OF MAINTENANCE

IMPORTANT NOTICE:-

There are **NO** user serviceable parts on this heater.

These heaters are vacuum filled with oil during manufacture. You **MUST NOT** attempt to insert or remove the heating oil - as any attempt to compromise the vacuum seal will result in a loss of oil and make the machine un-useable. Any damage caused by oil leakage due to any tampering with the heater is not the liability of Draper Tools Limited.

Regular inspection and cleaning reduces the necessity for maintenance operations and will keep your product in good working condition.

If the replacement of the supply cord is necessary, this has to be done by the manufacturer or his agent in order to avoid a safety hazard. There are no other serviceable or replacement parts for this appliance. When the appliance is at the end of its working life it must be decommissioned.

Remove the plug from the socket before carrying out adjustments, servicing or maintenance.

Allow sufficient time for the heater to cool before attempting to adjust, service or maintain the heater.

Regularly vacuum dust from the outlet and ventilation grills. If necessary, wipe the housing with a lightly dampened cloth but **ONLY** when the heater is cold and unplugged from the mains power supply.

Do not use a wet cloth, solvents or abrasive cleaning agents to wipe the heater.

10. DISPOSAL

10.1 DISPOSAL

- At the end of the machine's working life, or when it can no longer be repaired, ensure that it is disposed of according to national regulations.
- Contact your local authority for details of collection schemes in your area.

In all circumstances:

- Do not dispose of power tools with domestic waste.
- Do not incinerate.
- Do not abandon in the environment.
- Do not dispose of WEEE* as unsorted municipal waste.



* Waste Electrical & Electronic Equipment.

11. EXPLANATION OF SYMBOLS

11.1 EXPLANATION OF SYMBOLS



Class 1 product, that requires an appropriate earth connection for safe and efficient operation.



WEEE
Do not dispose of Waste Electrical
& Electronic Equipment in with
domestic rubbish

- **DRAPER TOOLS LIMITED,**
Hursley Road, Chandler's Ford,
Eastleigh, Hampshire. SO53 1YF. U.K.

- **Helpline:** (023) 8049 4344
- **Sales Desk:** (023) 8049 4333
- **Internet:** www.draper.co.uk
- **E-mail:** sales@drapertools.com
- **Sales Fax:** (023) 8049 4209
- **General Enquiries:** (023) 8026 6355

- **Service/Warranty Repair Agent**
For aftersales servicing or warranty repairs, please
contact the Draper Tools Helpline for details of an
agent in your local area.

YOUR DRAPER STOCKIST